

Item List

- ① LANC transmitter
- ② LANC receiver
- ③ Cable
- ④ Single rod clamp
- ⑤ Double-thread screw

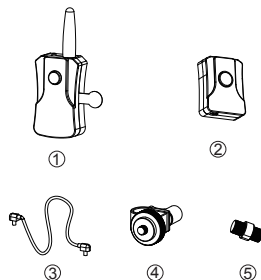

☎ 0769-8188 9368
 ✉ info@lanparte.com
 🌐 <http://www.lanparte.com>
 📍 39#,xin'an 2nd road chang'an town
 Dongguan City Guangdong China(PRC)

LanParte

Lanparte LANC wireless controller LANC-02

Instruction

- ① Please move away the insulating piece at first.

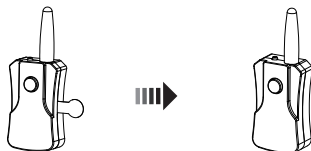

- ② There is 1/4-20 thread hold on the back of the receiver. Receiver can connect with the double-thread screw and then attach to the equipment with 1/4-20 thread hole.



- ③ There is 1/4-20 thread hold on the back of the transmitter. Transmitter can connect with the single rod clamp and then attach to the 15 mm rod.

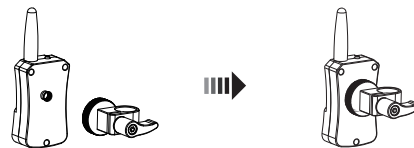

- ④ Pairing and Operation Instruction (Usually, pairing is completed before delivery and controller can be used directly)

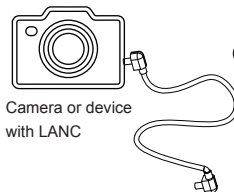

- a** To connect the spring cable (or straight cable) to camera (or device with LANC). Then turn on the camera.
 Remarks: Both ends of the cable are the same.

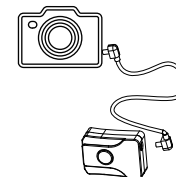

- b** Long press the red button on the receiver and connect the receiver to the other end of the cable till the light on the receiver blink. Then release the button on receiver and press the button on transmitter. Both the lights on the transmitter and receiver will blink and then go off which indicates the completion of pairing, then release the button on transmitter. One transmitter can be paired to one or more receivers.

- c** After pairing, you can control the camera start and stop recording with the red button on the transmitter.

Remarks: 1. It is compatible with only SONY and Blackmagic machines with a LANC port.
 2. The transmitter is powered with button cell. Please open to change battery when the transmission distance becomes shorter

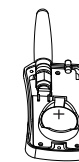
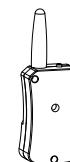

* Please make sure the battery positive pole is upward.