

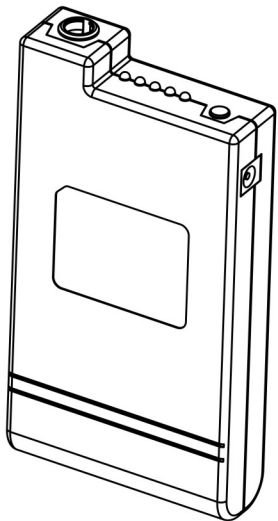

**Lanparte
portable battery**

**LPT-PB-600
USER MANUAL**



Lanparte portable battery
P8-600

Voltage:7.4V

Amper/hour:6.6Ah

Watt-hour:44.4Wh

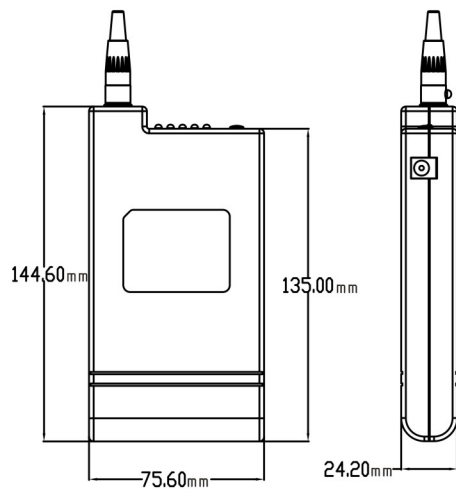

Dimensions of
PB-600

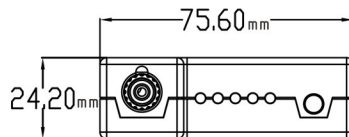

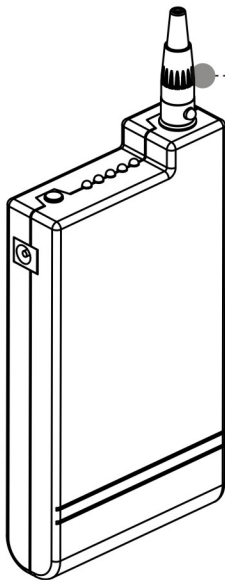

How the PB-600 works

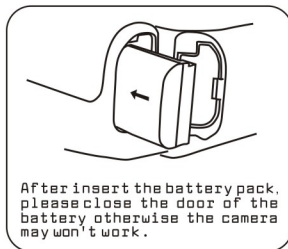
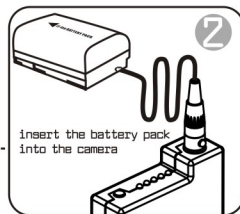
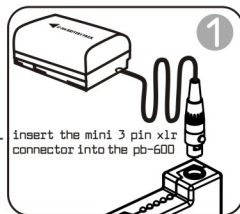

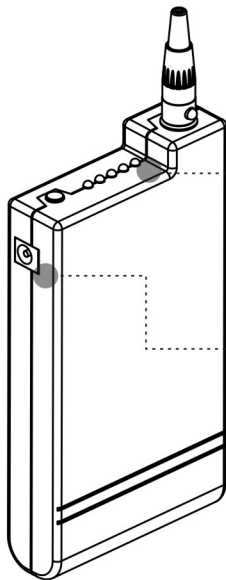

When charging the light turn red

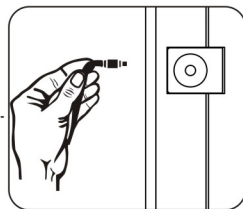
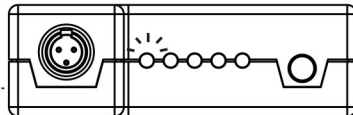

Charging: insert the dc connector into the DC jack

Note: the PB-600 has short circuit protection function once the battery won't work please use the charger to activate the battery

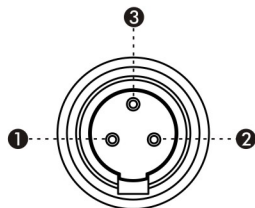
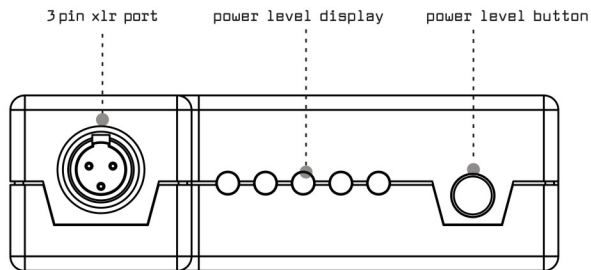

Pin instruction

- ① 12 V
- ② Ground
- ③ Empty



Note: Please don't insert the 3pin xlr connector made by other companies into the PB-600.

Note

Warning: fire, explosion, and burn hazard.

Do not open battery, dispose of in fire, heat above 100°C (212°F), expose contents to water, recharge, put in backwards, mix with used or other battery types - may explode or leak and cause personal injury.

SHIPMENT

The battery should be packed in cartons under the condition of half capacity 20-50% for shipment. The Violent vibration, impaction or squeezing should be avoided in the transport process; neither is exposed in the sunlight nor rain. The batteries shall be shipped by normal transportation such as by road, by train,

STORAGE

The battery storage shall be in the clean and dry ventilation room at the temperature of -5 ~ 35 °C and shall keep out of fire or heat and avoid touching corrosion elements. The batteries shall be charged every 6 months during storage.

CHARGING METHOD

Use the special chargers in the recommended charging method to charge the battery.

SAFETY USAGE GUARANTEE

If the battery is used on other instruments, please contact with your manufacturer for how to get the best performance, at least consult its maximum current, fast charge and special application.

ENVIRONMENT PROTECTION THIS PRODUCT ACCORD WITH ROHS REQUIREMENT.



CELL PERFORMANCE TESTING PARAMETERS

Code	Test Content	Standard Value
VDET1	Overcharge Protection Voltage	$4.35 \pm 0.025V$
VDET2	Over Discharge Cut Off Voltage	$2.7 \pm 0.08V$
ISTANDY	Over Discharge Cut Off Current	$3.0 \pm 1A$
TVDET1	Charge Protection Delay Time	1S
TVDET2	Discharge Protection Delay Time	128ms
TVDET3	Discharge Current Protection Delay Time	12ms
TVDET4	Overcharge Current Protection Delay Time	8ms
ISTANDY	Auto Static Current Consumption	protection module $4.0\mu A \times 2$; LCD module 7mA
RDS	Impedance	$R \leq 50$ milliohm

HongKong Lanparte Technology Limited

Tel :+86-769-81888368

Fax :+86-769-85841828

Email:info@lanparte.com

Add :39#, xin'an 2nd Road Chang'an Town
Dongguan City Guangdong China(PRC)

<http://www.lanparte.com>

Hotline:+86-400-602-6822